

Tenda



IT6-PRS

3MP PoE Infrared Bullet Security Camera



IT6-PRS

3MP PoE Infrared Bullet Security Camera

Product Description

3MP Bullet Security Camera IT6-PRS is a high-performance 3MP (2304x1296) engineering camera that integrates such functions as infrared night vision, motion detection, remote audio pickup and PoE. It is commonly used in factories, courtyards, shops, buildings, and some small and large monitoring scenarios where contractors can use their mobile phones for remote real-time monitoring.

Selling Points



Clear monitoring details from 3MP HD images

Equipped with a high-performance image sensor, the camera can display 3MP HD images (2304*1296) with more monitoring details.

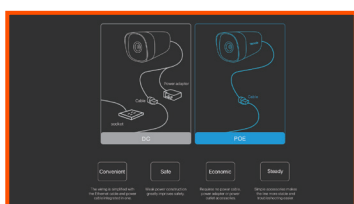

Many advantages with standard PoE power supply

Convenient: The wiring is simplified with the Ethernet cable and power cable integrated in one.

Safe: Weak power construction greatly improves safety.

Economic: Requires no power cable, power adapter or power outlet accessories.

Steady: Simple accessories makes the line more stable and troubleshooting easier.



Connect to the PoE network video recorder (NVR) for small networking

For such small monitoring scenarios as small shops and restaurants. Monitoring requirements can be met by simply connecting the camera to the PoE NVR.



Connect to the PoE switch for medium and large networking

For such medium and large monitoring scenarios as markets, industrial zones and car parks, you can connect the camera to the PoE switch for networking.

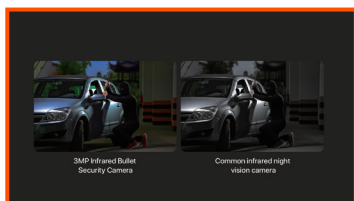

Starlight night vision with good low-light performance at the price of infrared night vision

With starlight night vision offered by the wide-aperture lens and highly sensitive sensor, the camera is more light-sensitive than common cameras and can display finer images than common infrared cameras.

Selling Points



Audio pickup over 5 m, sync audio and video

With an inbuilt highly sensitive microphone which supports remote audio pickup over 5 m, the camera can sync audio and video.



High compatibility

Support ONVIF, it can be used with mainstream NVRs in the market, featuring high compatibility.

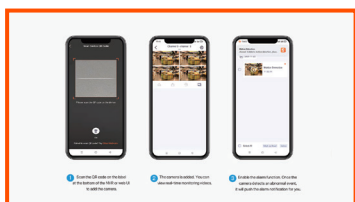

Remote control for light of heart

The camera supports remote control on the app to view real-time monitoring. Once the device detects an abnormal event, it can push the alarm notification remotely.



IP66 waterproof and dustproof

With IP66 waterproof and dustproof design, the camera can withstand rainy, sunny, stormy, and even snowy weathers.

Specification

Hardware Specifications	
Ports	Power: DC 12V 1A Ethernet: 1*RJ45 100M Ethernet port on tail line
Lens	4mm@F2.2
Product Size	85×85×166mm
Video Specifications	
Resolution	2304 x 1296
Coding Standard	H.265/H.264
Day and Night Shift Mode	Built-in IR-CUT double filter
Noise Reduction	3D digital noise reduction
DWDR	Support
Backlight Compensation	Support
ROI	Support
Others	
Smart Alarm	Motion detection&Human detection&Customized area detection
Waterproof level	IP66
Audio	Built-in microphone
Network Protocol	RTSP、HTTP、DHCP、DDNS、ONVIF
Internet Protocol	IPV4
Device Connection Method	Wired
Infrared Night Vision Distance	50 Meters
Temperature	Operating temperature: -20°C to 60°C Storage temperature: -40°C to 70°C
Humidity	Operating humidity: 10%-95%RH (non-condensing) Storage humidity: 3%-95%RH (non-condensing)
Certification	CE, RoHs, FCC
Package Contents	Security Camera, Waterproof kit,Quick installation guide, General public license notice

SHENZHEN TENDA TECHNOLOGY CO.,LTD.

Tenda Technology Bldg.Int'l E-City,
#1001 Zhong Shan Yuan Rd.,Nanshan District,She n zhen China.

E-mail:support@ tenda.com.cn

Tel:+86-755-2 765 7098

Fax:+86-755- 2765 7178

PC:518055

